



CustomControlSensors

**Dual Snap®**  
Pressure, Temperature and Liquid Flow

[www.ccsdualsnap.com](http://www.ccsdualsnap.com)

Custom Control Sensors, Inc. (CCS) has been a global leader in the design, testing, manufacturing and supply of standard and custom pressure, temperature and flow switches for the Aerospace, Defense, Industrial and Energy markets since 1958. CCS switches are highly reliable devices that utilize a DUAL-SNAP™ action disc spring principle pioneered by Custom Control Sensors over 50 years ago.

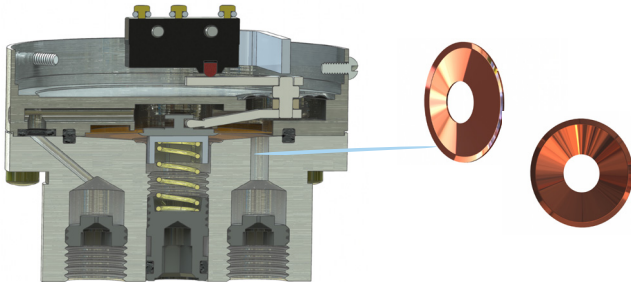

CCS' Airborne Division provides standard and custom switches for the aerospace, defense, commercial and business aviation markets. CCS also manufactures originally designed PMA parts for Boeing, Airbus and numerous general aviation aircraft.

CCS switches cover pressure ranges from .25" H<sub>2</sub>O to 16,000 psi. Switch service life ranges up to 500,000 operating cycles and proof pressures to 25,000 psi. CCS switches are designed to operate in ambient temperature ranges from -65°F to 450°F, withstand vibration up to 40G's at 3,000 Hz and shock loads up to 250G's.

All Dual-Snap aerospace switches are designed or can be modified to meet various requirements of MIL-DTL-9395, MIL-STD-810, MIL-STD-202 or RTCA/DO-160. These requirements, among others, include Environmental test requirements such as salt spray, temperature cycling, humidity, sand and dust, moisture resistance; physical characteristic tests such as vibration, shock, and acceleration; electrical characteristic tests such as dielectric, insulation resistance and contact resistance.

CCS is a privately held company and ISO 9001:2008 & AS9100 approved.

### Time-Tested Solutions. Reduced Costs & Time.

For Aerospace OEM and Defense related inquiries, please contact us:

For Commercial Aviation aftermarket spares, please contact Seal Dynamics:



CustomControlSensors

United States Office  
21111 Plummer Street  
Chatsworth, California 91311  
Tel: +1 818.341.4610  
[switchnet@ccsdualsnap.com](mailto:switchnet@ccsdualsnap.com)



600 Prime Place  
Hauppauge, New York 11788 U.S.A  
Tel: +1 800.344.8724 or +1 631.667.4000  
Fax: +1 631.667.4030  
[info@sealdynamics.com](mailto:info@sealdynamics.com)  
[www.sealdynamics.com/contactus.html](http://www.sealdynamics.com/contactus.html)



#### Airbus A320

CFM 56-5A-C Engines  
Differential Pressure  
Fuel Pressure  
Oil Pressure



#### Boeing 747-8

Fuel Pressure  
Hydraulic Pressure  
Oil Pressure  
Pneumatic Pressure  
Water Pressure



#### Dassault Falcon 900

Fuel Pressure  
Hydraulic Pressures  
Oil Pressure  
Pneumatic Pressure



#### Bell 412

Fuel Pressure  
Oil Pressure



#### Lockheed F-22A Raptor

Fuel Pressure  
Oxygen System Pressure



#### Bell V-22 Osprey

Hydraulic Pressure  
Fuel Pressure  
Lube Oil Temperature  
Pneumatic



CustomControlSensors

Dual Snap®

Pressure, Temperature and Liquid Flow

www.ccsdualsnap.com



### 1G Series Gage

#### Diaphragm Seal

- **Operating Range:** 0.5 to 100 PSIG
- **Proof Pressures up to:** 1,000 PSIG
- **Weight:** 4 oz. (approx.)
- Low range pressure switch for fuel or pneumatic systems.
- Service life to 150,000 cycles at 100% of range.

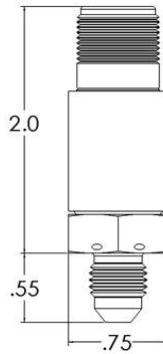
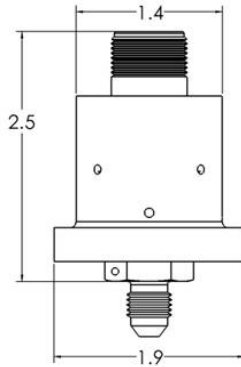

### 7G Series Gage

#### Diaphragm Seal

- **Operating Range:** 15 to 1000 PSIG
- **Proof Pressures up to:** 5,000 PSIG
- **Weight:** 2 oz. (approx.)
- Lightweight, miniaturized switch for hydraulic, pneumatic or fuel systems.



### 7G Series Gage

#### Piston O-ring Seal

- **Operating Range:** 250 to 5,000 PSIG
- **Proof Pressures up to:** 12,000+ PSIG
- **Weight:** 3 oz. (approx.)
- Gage pressure switch with piston type sensing element for hydraulic applications. High shock resistance.
- Service life to 500,000 cycles at 100% of range.

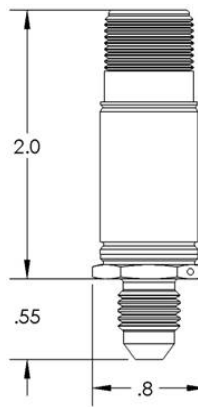
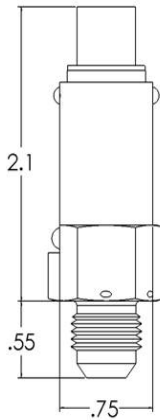

### 8A and 8G Series Absolute \* Gage

#### Diaphragm Seal

- **Operating Range:** Absolute Pressure: 0.5 to 300 PSIA
- **Gage Pressure:** 0.5 to 1,500 PSIG
- **Proof Pressures up to:** 500 PSIA or 5,000 PSIG
- **Weight:** 1.5 oz. (approx.)
- Lightweight, miniaturized switch with high vibration and shock resistance for hydraulic, pneumatic or fuel systems.



### 42G and 42D Series Gage \* Differential

#### Diaphragm Seal

- **Operating Range:** Gage Pressure: 1.5 to 100 PSIG
- **Differential Pressure:** 1.5 to 100 PSID
- **Proof Pressures up to:** 250 PSIG
- **Weight:** 9 oz. (approx.)
- Low range switches for hydraulic, pneumatic or fuel systems.

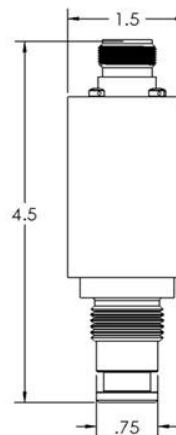
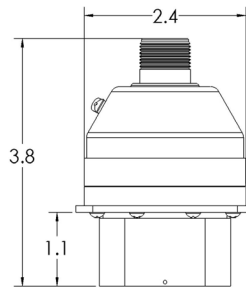

### 90G Series Gage

#### Piston O-ring Seal

- **Operating Range:** 250 to 4,000+ PSIG
- **Proof Pressures up to:** 7,500+ PSIG
- **Weight:** 6 oz. (approx.)
- Mid to high range gage pressure switch with piston type sensing element for hydraulic systems. High shock resistance.
- Service life to 500,000 cycles at 100% of range.



### 150T Series Temperature Probe

#### Probe

- **Operating Range:** 25 to 800 degrees F
- **Proof Temperature:** 100 degrees F above set point standard.
- **Weight:** 2.5 oz. (approx.)
- Lightweight, miniaturized switch with high vibration and shock resistance for hydraulic, pneumatic or fuel systems.

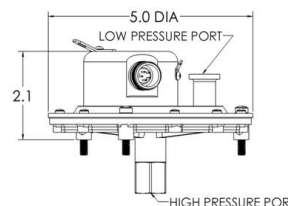
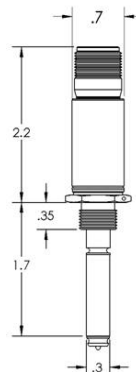

### 75D, 75G and 75V Series Differential \* Gage \* Vacuum

#### Diaphragm Seal

- **Operating Range:** .25" to 30" H2O
- **Proof Pressures up to:** 100 PSIG
- **Weight:** 12 oz. (approx.)
- Vacuum range suitable for use in gage or differential applications in pneumatic or fuel systems.

